

PCTR : PURE CONICAL TIP RUBBER
FCTR : FLIP-CHIP CONICAL TIP RUBBER
BPCT : BLACK PLASTIC CONICAL TIP

Thermoplastic elastomer combines the properties of thermoplastics and rubbers in one polymer. The very high purity has made 74A the material of choice for many products in the medical and pharmaceutical industry. It is therefore well suited to the increasing demand of higher quality tools for the microelectronic world.



Features

- **Very high purity**
- **Static Dissipative**
- **Small wall size**
- **Flexible design**
- **Leaves no dark mark on die**
- **Molded finished to shape**
- **Very reproducible geometry**
- **Special formulation for Flip Chip**
- **Custom molded tip design**
- **Spring effect for small tip sizes**

Being aware of the need to offer products able to cope with today's large and diverse application, SPT proposes a version of FCTR tips tailored specifically for the requirements of Flip-chip assembly.



PCTR-A-060



BPCT-A-040



FCTR-C-200



Clean Packing

All thermoplastic tips are individually segregated in anti-static boxes and packed under filtered laminar air flow class 100. The tip surface remains protected from friction or contact with neighbors or foreign material. Quantity per box: 20 pieces



Available Molded BPCT/PCTR & FCTR Size

Type BPCT / PCTR	Type FCTR	Face Diameter ØF inch / mm	Wall Thickness WT inch / mm	Shank Insert	
				BPCT / PCTR	FCTR
BPCT/PCTR -A-020	NA	.020 / 0.50	.0050 / 0.13	A/B XS	-
BPCT/PCTR -A-025	NA	.025 / 0.63	.0064 / 0.16	A/B XS	-
BPCT/PCTR -A-030	NA	.030 / 0.76	.0050 / 0.13	A/B	-
BPCT/PCTR -A-035	NA	.035 / 0.90	.0075 / 0.19	A/B	-
BPCT/PCTR -A-040	NA	.040 / 1.02	.0100 / 0.25	A/B	-
BPCT/PCTR -A-045	NA	.045 / 1.14	.0090 / 0.23	A/B	-
BPCT/PCTR -A-050	FCTR-A-050	.050 / 1.27	.0115 / 0.29	A/B	A/B XL
BPCT/PCTR -A-060	FCTR-A-060	.060 / 1.52	.012 / 0.30	A/B	A/B XL
BPCT/PCTR -A-070	FCTR-A-070	.070 / 1.78	.012 / 0.30	A/B	A/B XL
BPCT/PCTR -A-080	FCTR-A-080	.080 / 2.03	.012 / 0.30	A/B	A/B XL
BPCT/PCTR -A-090	FCTR-A-090	.090 / 2.29	.010 / 0.25	A/B	A/B XL
BPCT/PCTR -A-100	FCTR-A-100	.100 / 2.54	.010 / 0.25	A/B	A/B XL
BPCT/PCTR -A-120	FCTR-A-120	.120 / 3.05	.010 / 0.25	A/B	A/B XL
BPCT/PCTR -A-140	FCTR-A-140	.140 / 3.56	.010 / 0.25	A/B	A/B XL
BPCT/PCTR -A-160	FCTR-A-160	.160 / 4.06	.010 / 0.25	A/B	A/B XL
BPCT/PCTR -A-180	FCTR-A-180	.180 / 4.57	.010 / 0.25	A/B	A/B XL
BPCT/PCTR -C-200	FCTR-C-200	.200 / 5.08	.016 / 0.40	C/D	C/D XL
BPCT/PCTR -C-220	FCTR-C-220	.220 / 5.59	.016 / 0.40	C/D	C/D XL
BPCT/PCTR -C-240	FCTR-C-240	.240 / 6.10	.016 / 0.40	C/D	C/D XL
BPCT/PCTR -C-260	FCTR-C-260	.260 / 6.60	.016 / 0.40	C/D	C/D XL
BPCT/PCTR -C-280	FCTR-C-280	.280 / 7.11	.016 / 0.40	C/D	C/D XL
BPCT/PCTR -C-300	FCTR-C-300	.300 / 7.62	.016 / 0.40	C/D	C/D XL
BPCT/PCTR -C-320	FCTR-C-320	.320 / 8.13	.016 / 0.40	C/D	C/D XL
BPCT/PCTR -C-360	FCTR-C-360	.360 / 9.14	.016 / 0.40	C/D	C/D XL
BPCT/PCTR -C-400	FCTR-C-400	.400 / 10.16	.016 / 0.40	C/D	C/D XL

The external PCTR diameter OD and the internal square insert dimensions are distributed in two possible sets: Insert type A & C. A few rectangular tips are also available on request. It is recommended to use SPT shanks with tight tolerances and proper design for high accuracy tip positioning and stability. The shank A/B XS give better support to very small tips. The shank XL is larger for tighter grip on soft material.

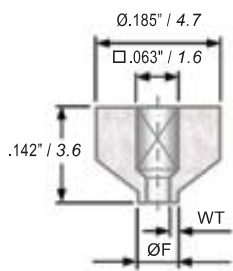

PCTR-A-020 to 080

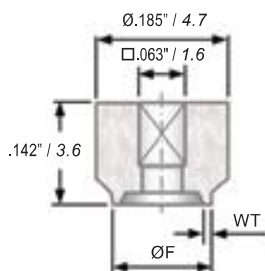

PCTR-A-090 to 180

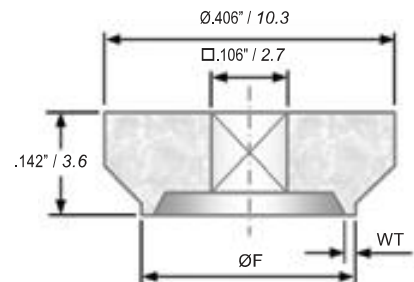

PCTR-C-200 to 400

How To Order				Shank Insert Types			
TIP ONLY	EXAMPLE :	Tip Configuration	- Insert Type	- Dimensions ØF	A/B XS	A/B	A/B XL
		PCTR	- C	- 260			
		FCTR	- A	- 160			
		BPCT	- A	- 040			
SHANK ONLY	EXAMPLE :	Shank Style & Length	- Insert Type		C/D	C/D XL	
		2102 - 19 GS	- A/B Shank - C/D XL Shank				