

DOUBLE CROSS GROOVE SINGLE POINT-TAB TOOL

7000 / 7100 STYLES

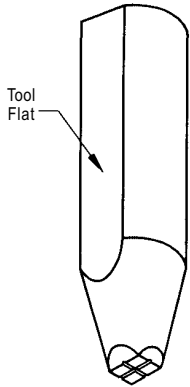

7000 STYLE

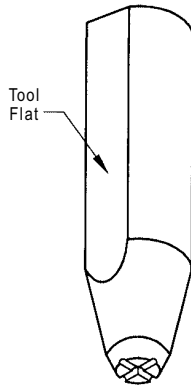

7100 STYLE

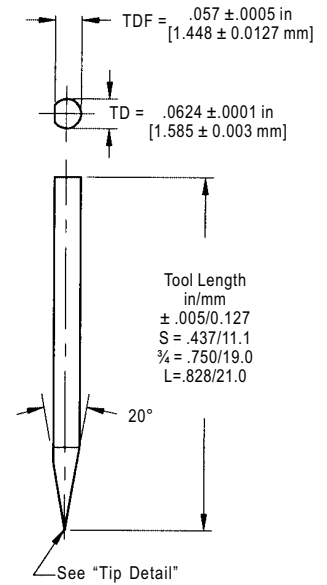

Other Tool Lengths Available

TIP DETAIL

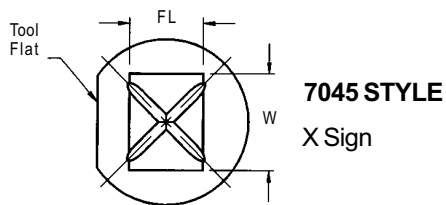
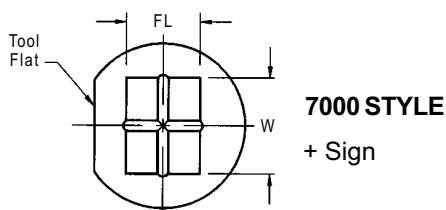
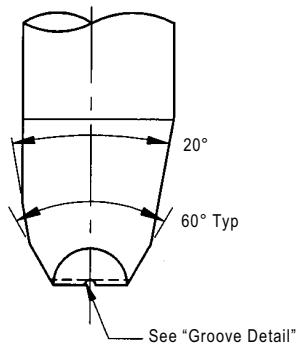

TIP DETAIL

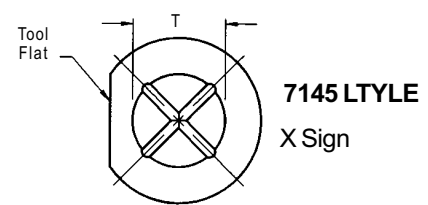
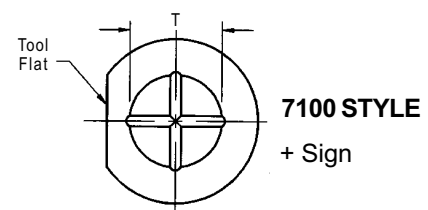
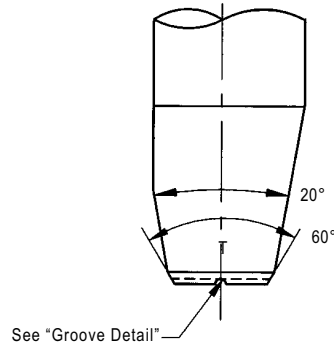

GROOVE DETAIL

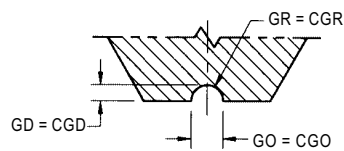

DOUBLE CROSS GROOVE SINGLE POINT-TAB TOOLS - GENERAL GUIDELINES ON HOW TO ORDER



**DOUBLE CROSS
GROOVE 7000 STYLE**



**DOUBLE CROSS
GROOVE 7100 STYLE**

STYLE		MATERIAL	
7000 / 7100 7045 / 7145	Double Cross Groove	AZO* DT C TI	Molded Ceramic (for high volume) Diamond Tip Cermet composite for Gold Wire (recommended for Low Temperature bonding) Titanium Carbide Composite for Gold Wire

TIP DETAILS		FOOT OPTIONS	
W/FL T	Specify "W" and "FL" Specify "T"	M	Matte Finish

HOW TO ORDER	
SPECIFY	Style/Groove Set - Material - W/FL or T - Tool Length - Foot Option
EXAMPLE	7000A- AZO - 4025 - S - M 7145B - DT- 0050 - .375- M 7045B - TI - 8060 - ¾- M

STANDARD GROOVE DIMENSIONS			
Groove Set	GO = CGO in / μ m \pm .0002/5	GD = CGD in / μ m \pm .0001/3	GR = CGR in / μ m (Ref)
A	.0010 / 25	.0005 / 13	.0005 / 13
B	.0015 / 38	.0008 / 20	.0008 / 20

Include Groove Set call out after Tool Style name to indicate which groove dimensions are desired.

STANDARD DIMENSIONS				
7000, 7045 Tool Style			7100, 7145 Tool Style	
W/FL	Foot Width W in / μ m \pm .0002/5	Foot Length FL in / μ m \pm .0002/5	T	Tip Diameter T in / μ m \pm .0002/5
4025	.0040 / 102	.0025 / 64	0030	.0030 / 76
4030	.0040 / 102	.0030 / 76	0035	.0035 / 89
4035	.0040 / 102	.0035 / 89	0040	.0040 / 102
4040	.0040 / 102	.0040 / 102	0045	.0045 / 114
5030	.0050 / 125	.0030 / 76	0050	.0050 / 125
5035	.0050 / 125	.0035 / 89	0055	.0055 / 140
5040	.0050 / 125	.0040 / 102	0060	.0060 / 152
5045	.0050 / 125	.0045 / 114	0070	.0070 / 178
5050	.0050 / 125	.0050 / 125		
5055	.0050 / 125	.0055 / 140		
6045	.0060 / 152	.0045 / 114		
6050	.0060 / 152	.0050 / 125		